

North Lake Shore- Sign Overview

Date: 11/12/2019

1. Project Scope

- a. Budgeted Approved with a max capital expenditure of \$21,000
- b. 1 single sided sign
- c. "Turn Key Project"- Existing Sign will be removed and new sign will be installed
- d. Top of the line finishes
- e. Once approved sign can be installed in 6-8 weeks (if ground is not frozen)
- f. Electrical will need to be contracted out
- g. Landscaping will need to be contracted out or completed by NLS member volunteers

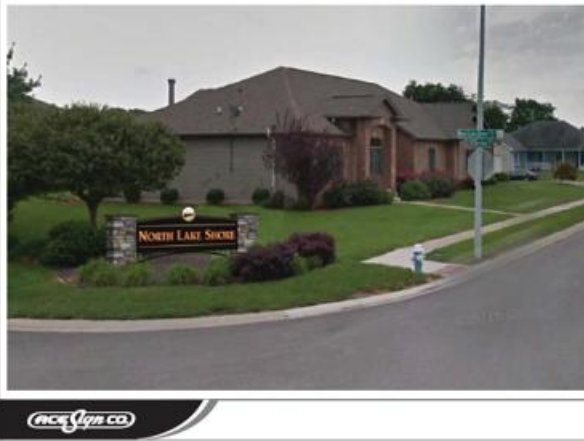

2. Project Cost

Project Cost	
Sign- Ace Sign	\$ 15,640
Permit- City of Springfield	\$ 125
Electical- Watts Electric	\$ 1,340
Landscape (estimate)	\$ 1,000
Project Contingency (5% estimate)	\$ 905
Total	\$ 19,010

3. Sign Inspiration

- a. Modeled After Iron Bridge Estates (Chatham)
- b. Per Ace Sign “The sign size that will adequately fit in the space is 13’-7” . This size matches what we did at Ironbridge Estates.”



4. Electrical

- a. Estimate Provided By Watts Electric
- b. Quote \$1,340
 - i. Directors will obtain additional quote and determine which vendor to utilize
 - ii. Cost will not exceed \$1,340
- c. Services Include – “INSTALLATION OF TWO 67 WATT LED, 8300 LUMENS, 5000K LIGHT FIXTURES (E-FFB08A-53VW50Z) AND REINSTALL SIGN PANEL AND WEATHERPROOF OUTLET FROM OTHER SIGN THAT WAS TAKEN DOWN”

5. Landscape

- a. \$1,000 Estimate (place holder)
- b. Assumed to be completed by North Lake Shore Member Volunteers

6. Project Scope (1 single sided sign)

"LOGO"
- 12mm Flat-cut PVC,
stud mounted w/ nylon spacers,

4" Aluminum Tube Cap
Painted MP Dur. Bronze Suede

4" Aluminum Extrusion
Painted MP Black Suede

"NORTH LAKE SHORE" - 2" HDU
Prismatic Dimensional Lettering,
stud mounted w/ nylon spacers,
GOLD LEAF

3mm ACP Background
MP Black Suede

1-1/2" Bent Horizontal
1" Verticals,
ALL Painted MP Black Suede

NOT TO SCALE (Reference Only)

4" Aluminum Extrusion
Cabinet, painted MP Black,
3mm ACP Background
Panel, painted MP Black Suede

4" Aluminum Tube Cap Element
Painted MP Duranodic Bronze Suede

Stone Columns (By Ace)
Square Aluminum Tube Frame
Versetta Stone Veneer (Sterling)

Caps: 2" Tubular Aluminum Caps,
countersunk screw mounted,
painted MP Duranodic Bronze Suede

4'-9"

9'-7"

2'

13'-7"

"LOGO" - 12mm PVC
Stud Mounted w/ nylon spacers

"NORTH LAKE SHORE" - 2" HDU
Prismatic Lettering, stud mounted,
GOLD LEAF

Site Plan

Existing

NEW SIGNS

Existing

Customer / Job Site

North Lake Shore Home Owners
W. Shore Dr. & Willow Springs Rd
Springfield, IL 62712

Scope of Work

Design, Furnish & Install (2) Custom Welcome Signs

BACKGROUND MEDIA	
QUANTITY	3mm ACP
SIZE	3'-2" x 9'-7"
INCLUDEMENT POINT	Black Suede
FINISH	STUDS / PRISMATIC
SCALE	LOWERS
SCALE	UPPERS
SCALE	CUSTOM
INDICATING SURFACES	
INDICATING SURFACES	

NON-LIGHTED LETTER SPECS	
Mounting Surface:	ACP
Mounting Device:	STUDS / PRISMATIC
Material:	HDU
Thickness:	2"
Letter Color/Finish:	MP Gold Metallic
Cut:	PRISMATIC

This design belongs to the ACE SIGN CO. and becomes the property of the customer only upon completion of an order, and is otherwise not to be used in whole or in part without written permission of ACE SIGN CO. • 2540 S. 1ST ST. • SPRINGFIELD, IL 62704 • 217 522-9417

JOB#: 92030
designed by: lg/DRS

PROOF DATE: 11/11/19

SCALE: 1/2" = 1'

APPROVED AS-IS APPROVED W/ CHANGES RE-DRAW W/ CHANGES

30 SQ. FT.